



## Welcome to Nipissing University Residence!

**We're thrilled to have you at Nipissing University! Returning and mature students can apply for residence based on availability. Simply complete your application and pay your deposit to be considered on a first-come first-served basis.**

### Your Support Network

- **Residence Life Supervisor:** Each residence has a dedicated supervisor to assist you.
- **Residence Dons:** Senior students are here to help with anything, from roommate issues to emergencies.
- **Events Galore:** Enjoy a year full of educational, social, cultural, and athletic events planned just for you.

### In-Residence Features

- **Stay Connected:** Wired and wireless internet throughout all residences.

- **Top Amenities:** Mail delivery, lounges, study rooms, climate control, vending machines, game rooms, laundry facilities, and ATMs.

### Meal Plans

Your suite has a full kitchen for you to cook your favourite meals. Prefer not to cook? Grab an optional meal card for easy, grab-and-go meals.

### Transportation Made Easy

- **City Transit Pass:** Included in your student fees for easy travel around North Bay.

- **Parking:** Available with a purchased pass. Plug-in parking is also available.
- **Grocery Bus:** Weekly service for convenient grocery shopping.

### Campus Safety

Enjoy peace of mind with 24/7 campus security, emergency phones, and video surveillance. Download the Nipissing Safe app for alerts and a virtual walk-home feature.

# Right where you belong

## Accommodation Options

Enjoy a relaxed lifestyle in our four-bedroom suites or select townhouse-style accommodations for mature, transfer and upper-year students, with six residents per house. All residences offer single bedrooms, a shared kitchen, a spacious living room, and two bathrooms for convenience.

## Maintenance and Services

While you keep your suite clean, our maintenance staff ensures common areas are spotless and comfortable, responding quickly to any service requests.

## Academic Support

Your success matters! Our Academic Dons and Residence Life staff host study groups and events with campus support services to help you thrive.

## Employment Opportunities

Earn while you learn with flexible on-campus jobs like caretakers and office assistants, letting you balance work and studies.

## Get Involved

Feel at home fast by joining the Residents' Council, university clubs, or intramural sports. Make lasting connections and enrich your university experience.

## How to Apply

**Online Applications Open in January:** Available through eRezLife ([nipissing.erezlife.com](http://nipissing.erezlife.com)). Create an account using your first name and the last six digits of your student ID number.

**Need Help?** Contact the Residence Admissions Office at 705-474-3450 ext. 4855 or [residence@nipissingu.ca](mailto:residence@nipissingu.ca).

We can't wait to welcome you to our vibrant and supportive residence community! For full details, visit [www.nipissingu.ca/residence](http://www.nipissingu.ca/residence).

Follow us!  @NUResidence



*Suite-style sample floor plan*

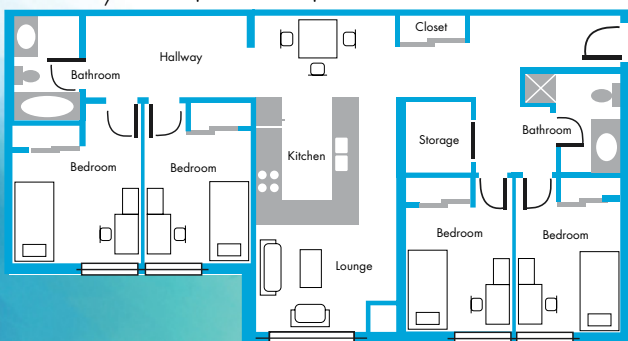

*Townhouse sample floor plan*

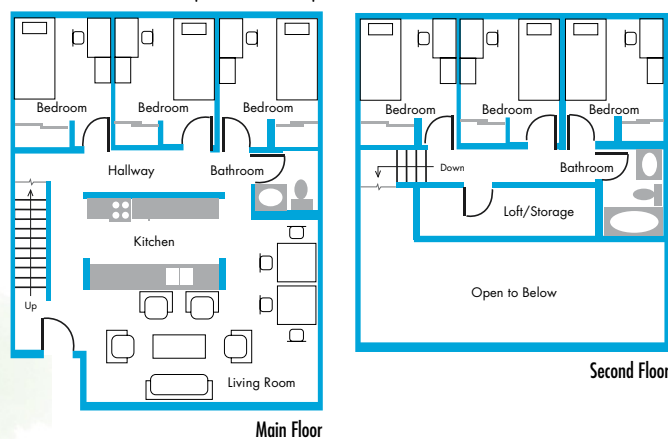

100 College Drive, Box 5002, North Bay, ON P1B 8L7

tel: (705) 474-3450, ext. 4855 • fax: (705) 474-7392 • [residence@nipissingu.ca](mailto:residence@nipissingu.ca) • [www.nipissingu.ca](http://www.nipissingu.ca)